

PARTS ORDERS FOR TRUESIGHT SENSOR – BEGINS 8/17/2023

Beginning Thursday, August 17, 2023, we will be changing all Truesight sales to the metric Truesight sensor.

Parts that are not changing – If the customer needs one of these, they can be ordered as is.

- 1) HT2128
- 2) HT2681
- 3) HT2690
- 4) HT2692
- 5) HT2695

All other parts are changing. They will be sold in “kits” rather than as individual parts.

OLD PART	NEW PART	KIT TO SELL
HT2501	HT2511	HT2511
HT2688	HT2512	HT2550
HT2669	HT2513	
HT2672	HT2572	HT2551
HT2685	HT2585	
HT2687	HT2587	

Pictures for each new kit are below:



Figure 1 - HT2551 assembly



Figure 2 - HT2550 kit

HT2550 can be used with the old Truesight cal shaft.

HT2551 can be used with the old Truesight block.

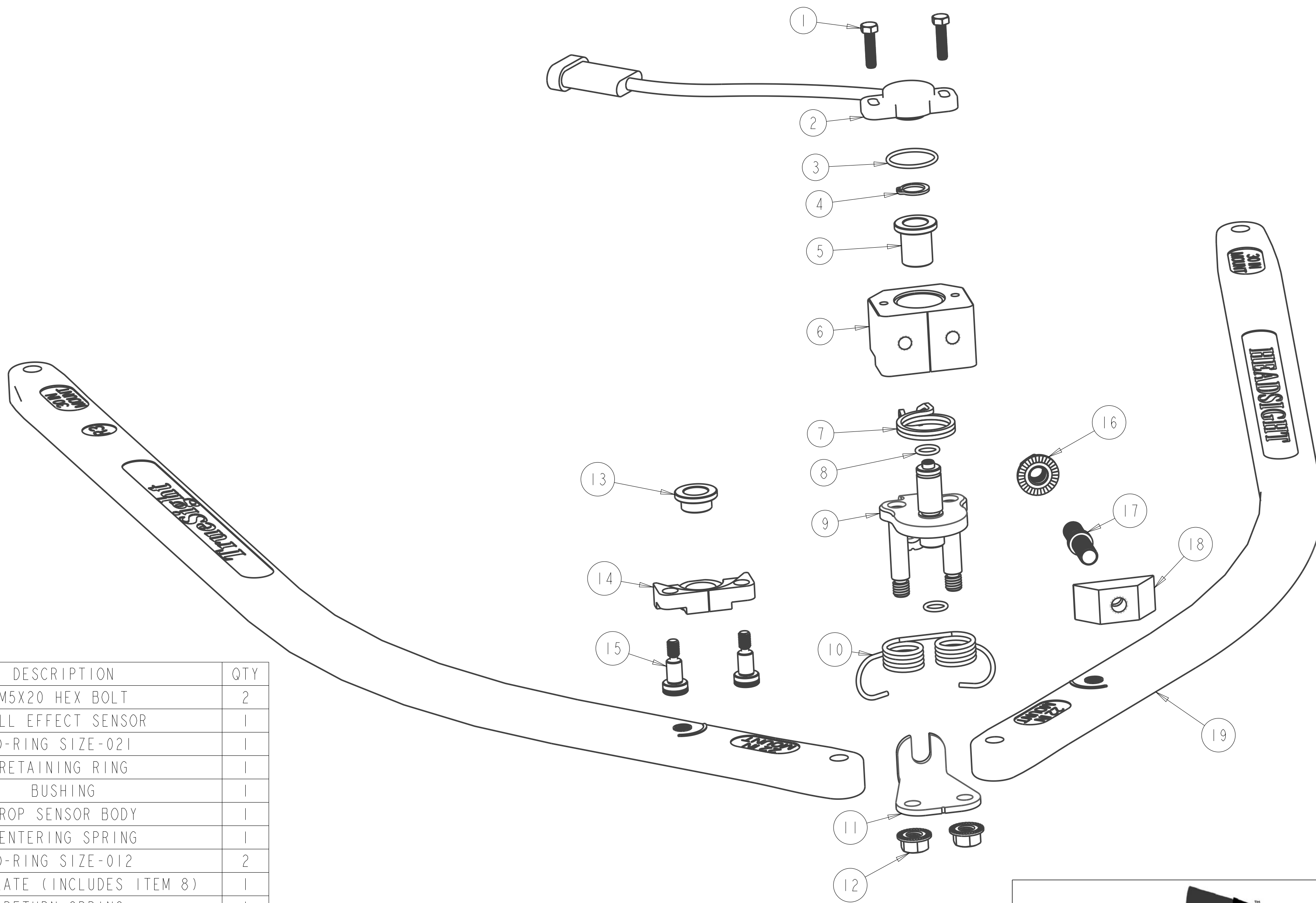

ITEM	PART NUMBER	DESCRIPTION	QTY
1	08200147	M5X20 HEX BOLT	2
2	HT2128	HALL EFFECT SENSOR	1
3	08100135	O-RING SIZE-021	1
4	08100132	RETAINING RING	1
5	08100130	BUSHING	1
6	HT2512	CROP SENSOR BODY	1
7	HT2690	CENTERING SPRING	1
8	08100138	O-RING SIZE-012	2
9	HT2572	PIVOT PLATE (INCLUDES ITEM 8)	1
10	HT2692	RETURN SPRING	1
11	HT2587	SUPPORT	1
12	08200119	M8 FLANGE NUT	2
13	08100143	BUSHING	1
14	HT2513	CROP SENSOR CAP	1
15	08200307	M6 SHOULDER BOLT	2
16	08200103	M10 FLANGE NUT	1
17	HT2585	SHAFT ADJUSTMENT STUD	1
18	HT2681	CALIBRATION WEDGE	1
19	HT2695	POLY WAND	2
20	HT2511	COMPLETE SENSOR (ASSEMBLY EXC ITEM 19)	

UNLESS OTHERWISE SPECIFIED DIMENSIONS ARE IN INCHES DIMENSIONS W/O TOL ARE BASIC	DATE AUG 14, 23												
 THIRD ANGLE PROJECTION	SHEET 1 OF 1												
THE INFORMATION CONTAINED ON THIS DRAWING IS PROPRIETARY TO HEADSIGHT. ANY UNAUTHORIZED USE OF SUCH CONTENTS IS STRICTLY PROHIBITED.													
MATERIAL N/A													
DESCRIPTION TRUESIGHT SENSOR PARTS													
<table border="1" style="width: 100%; border-collapse: collapse;"> <thead> <tr> <th colspan="2">TOLERANCE</th> </tr> </thead> <tbody> <tr> <td>x . x</td> <td>= ± .030</td> </tr> <tr> <td>x . xx</td> <td>= ± .010</td> </tr> <tr> <td>x . xxx</td> <td>= ± .005</td> </tr> <tr> <td>ANGLES</td> <td>= ± 1/2°</td> </tr> </tbody> </table>	TOLERANCE		x . x	= ± .030	x . xx	= ± .010	x . xxx	= ± .005	ANGLES	= ± 1/2°	<table border="1" style="width: 100%; border-collapse: collapse;"> <tr> <td style="width: 80%;">HT2511_PARTS</td> <td style="width: 20%;">CHG LEVEL 02</td> </tr> </table>	HT2511_PARTS	CHG LEVEL 02
TOLERANCE													
x . x	= ± .030												
x . xx	= ± .010												
x . xxx	= ± .005												
ANGLES	= ± 1/2°												
HT2511_PARTS	CHG LEVEL 02												